

University of Queensland Link Bridge Bus Station Link and Union Complex Upgrade

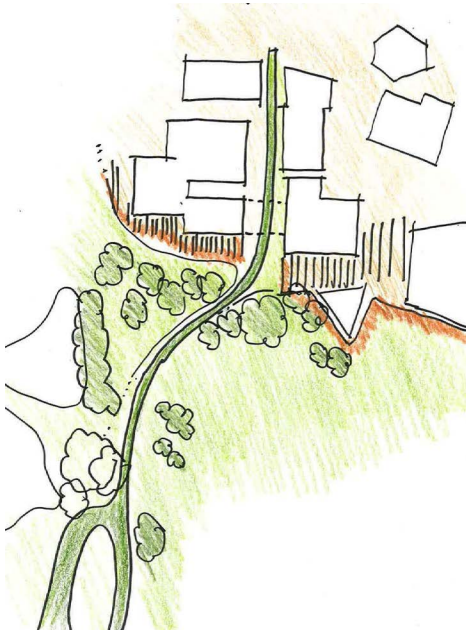

lahznimmo architects were commissioned by the University of Queensland for the design of a new accessible pedestrian link from The Lakes Bus Station to the Academic core of the campus. The link needed to cater for up to 20,000 arrivals and departures to and from the campus each day, making it one of the Universities major entrances. The proposed pathway rises approximately 8 metres from the flood prone Lakes wetlands to the eastern end of the Union Complex and a further 7 metres through the Union Complex food court to Campbell Place.

To accommodate the rise a suspended timber walkway was proposed from the bus station, rising at a gradual 1:35 above the Lakes wetland. When the pathway meets grade again a gradual stair and a stone clad lift provide access to a new landscaped eastern forecourt to the Union Complex.

A reorganisation of the lower levels of the Union Complex was proposed to provide external access through the Union to Campbell Place. This strategy re-orientates the existing constricted and confused pedestrian pathway, bypassing the existing busy food court, allowing for more generous access for all.

Client: The University of Queensland
Country: Yuggera Nation
Location: St Lucia, QLD
Project Value: \$10 Mil

